

Cornavin Railway Station (Switzerland)



Project description

The aging "Gare de Cornavin" building and the related signs of wear and tear, SBB has decided to renovate the building. As part of this renovation work carried out in 2016, the required expansion joint will also be completely replaced, as it was no longer sufficient to meet the requirements.

Absolute watertightness combined with a long service life and a consistent anti-skid surface with equal levels on both sides of the joint are the key features that the new joint system has to fulfil.

mageba scope

mageba supplied and installed 85 m of the MIGUTAN expansion joints.

Due to the great variations of the corner angles, wall connections and cover plates, it was decided to use the MIGUTAN expansion joint system, which enables completely watertight connections.

Other advantages of the joint includes the short installation time and cost effectiveness.

In addition, the watertight MIGUTAN joint can be fitted with a wide range of caps, seals and other parts which provide a comprehensive solution for all construction requirements, without the need to develop any special design.

Highlights & Facts

mageba Products:

Type:	MIGUTAN expansion joints
Features:	Waterproofing conjunction with fluid sealants
Installation:	2016

Structure:

City:	Geneva
Country:	Switzerland
Type:	Railway station
Completed:	2016
Owner:	SSB
Contractor:	Bernsaconi & Cie SA

The railway station is located in the Swiss town of Geneva



The cross-section of the installed MIGUTAN joint with stainless steel cover

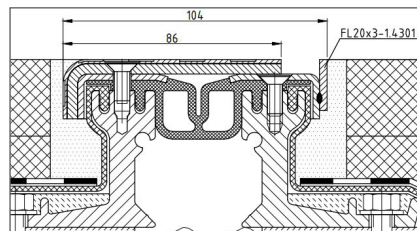

Installed joint with non-skid cover plate

